

UNIVERSITY OF UTAH

Project Location:

- Salt Lake City, Utah

Client:

- University of Utah Campus Design and Construction
- State of Utah, Division of Facilities Design and Construction

Project Design Features:

- Eccles School of Business Addition and Remodel
- College of Nursing Addition and Remodel
- Guest House Addition
- Museum of Natural History New Building Site

Project Team consists of:

- Dominion Engineering



Dominion is responsible for the following:

- ALTA/ACSM Land Title Surveys to facilitate design of additions, new improvements, utilities, roads and buildings
- Preparation of detailed topographic mapping of all visible improvements, buildings, trees and utilities
- Surveyed utilities including depth, size and type
- Establish horizontal and vertical control monuments for use in project development and construction
- Coordinate with project contractors, engineers and architects to provide detailed mapping and measurements to address specific design considerations

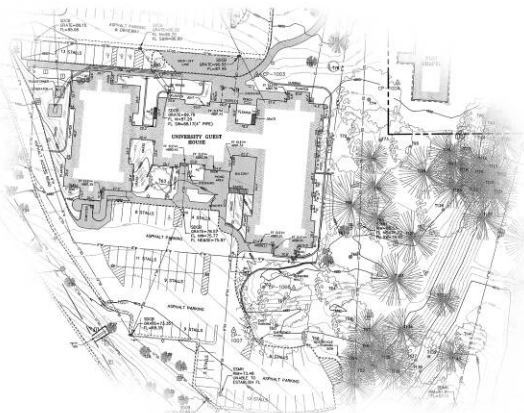

University of Utah Guest House

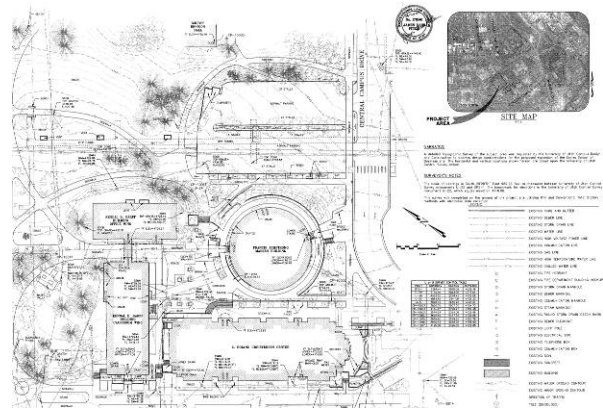

University of Utah Eccles School of Business